

7

- 2x [1x2 black Technic brick]
- 1x [1x2 black Technic brick with 2 holes]
- 4x [grey Technic axle]

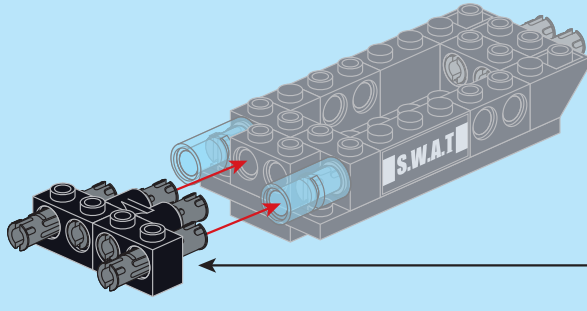

1

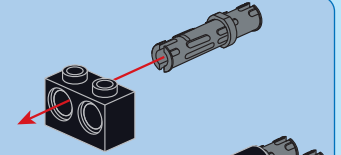

2

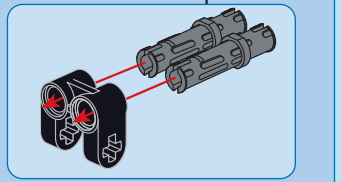
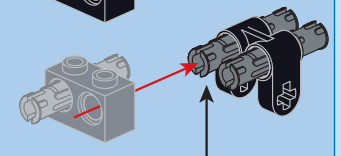

3

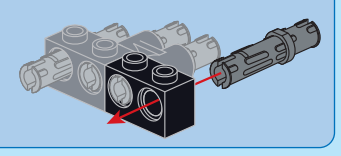

1

- 1x [4x8 black Technic plate]
- 1x [1x2 black Technic brick]

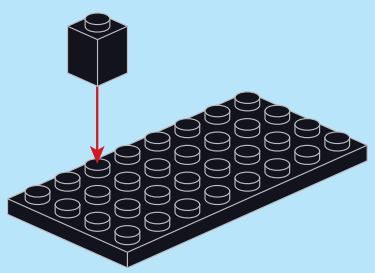

2

- 2x [1x2 black Technic brick]
- 1x [grey Technic axle]

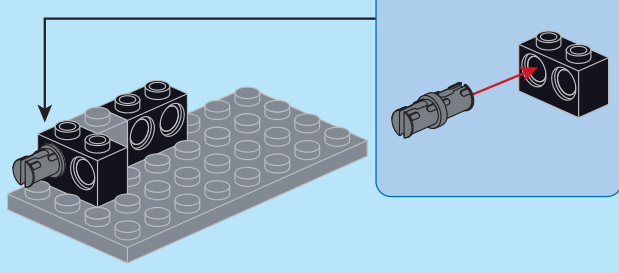

3

- 1x [1x2 black Technic brick]
- 1x [1x2 black Technic brick with 2 holes]

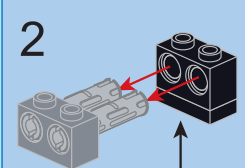
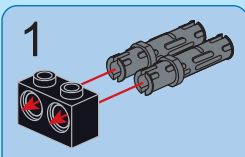
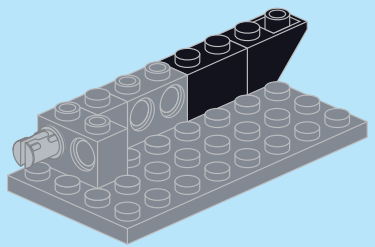

4

- 3x [1x2 black Technic brick]
- 1x [1x2 black Technic brick with 2 holes]
- 2x [grey Technic axle]

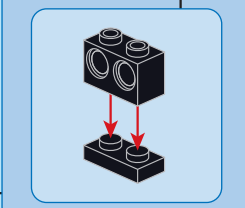
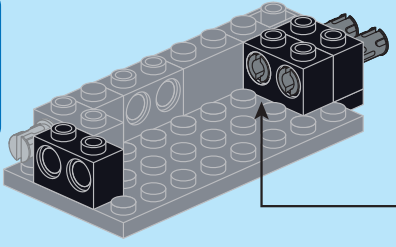

5

- 1x [1x2 black Technic brick]
- 1x [1x2 black Technic brick with 2 holes]
- 1x [1x2 black Technic brick]
- 1x [grey Technic axle]

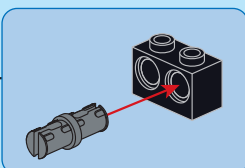
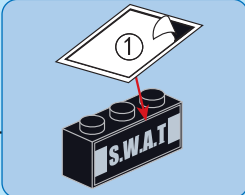
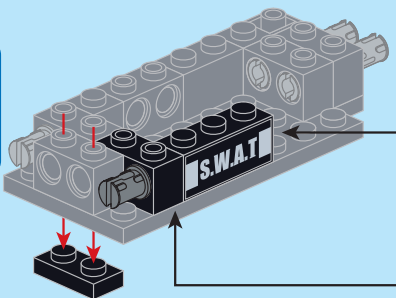

6

- 1x [1x2 black Technic brick]
- 1x [1x2 black Technic brick with 2 holes]
- 2x [grey Technic axle]

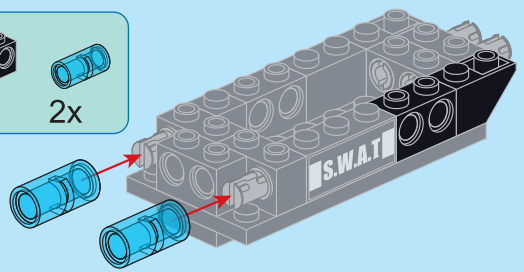

8

- 1x [4x10 black Technic plate]
- 1x [1x2 black Technic brick]

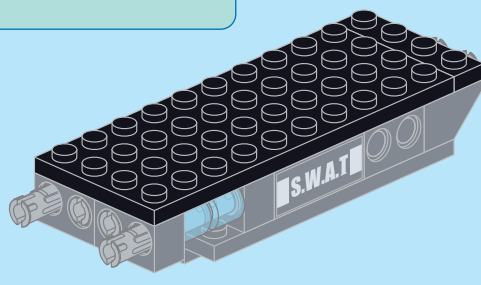

9

- 2x [black Technic brick]
- 2x [red Technic pin]

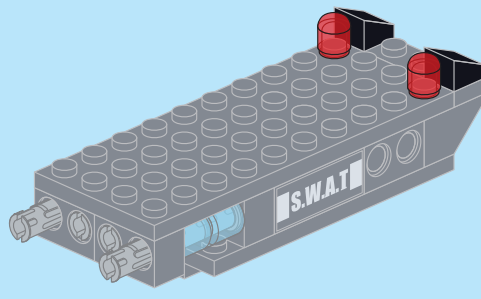

10

- 1x [1x4 black Technic plate]
- 1x [black Technic brick]
- 1x [black Technic brick]
- 2x [grey Technic axle]
- 1x [grey Technic axle]

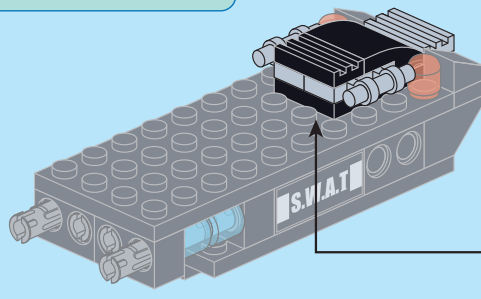

1

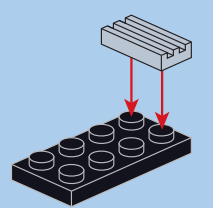

2

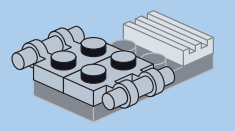

3

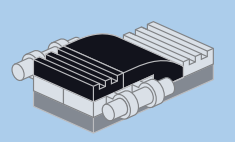

11

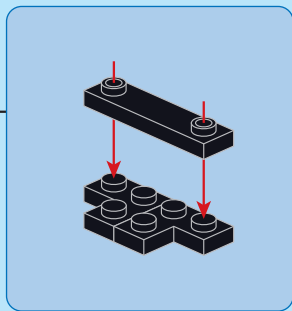
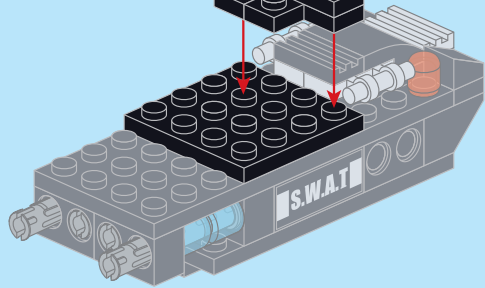
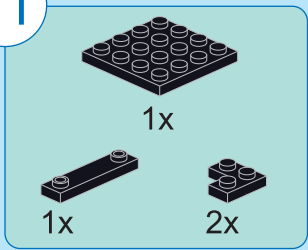

15

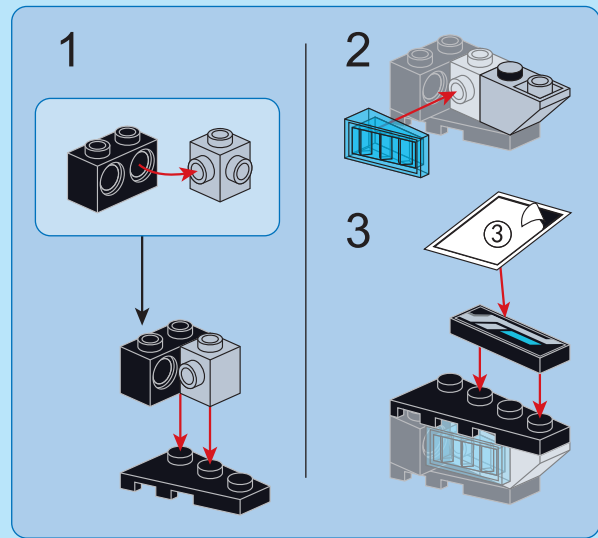
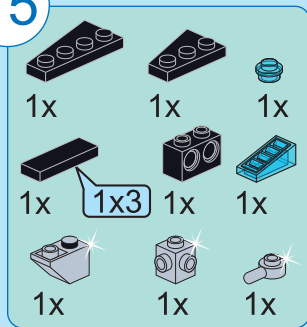

12

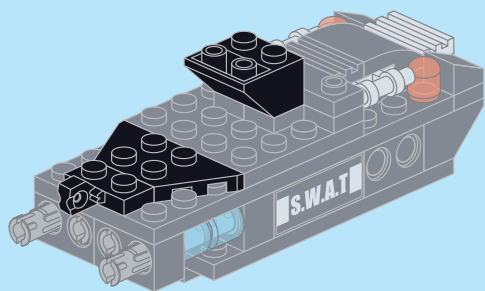
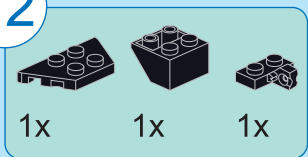

16

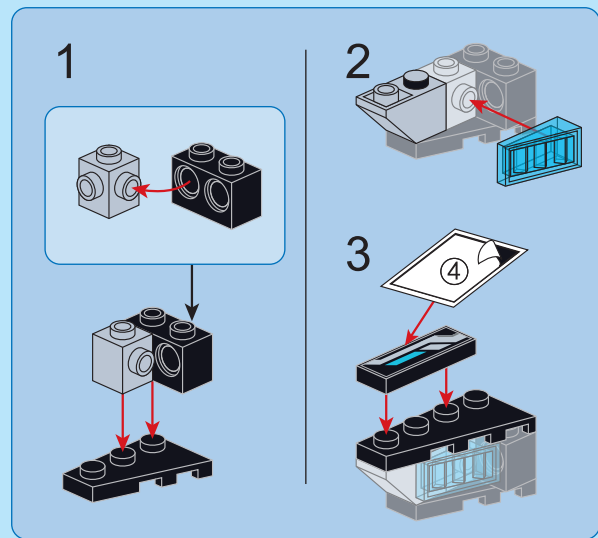
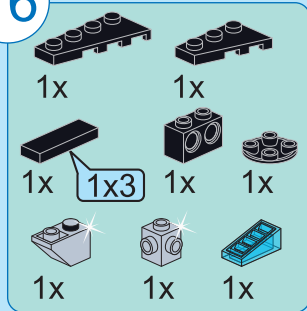

13

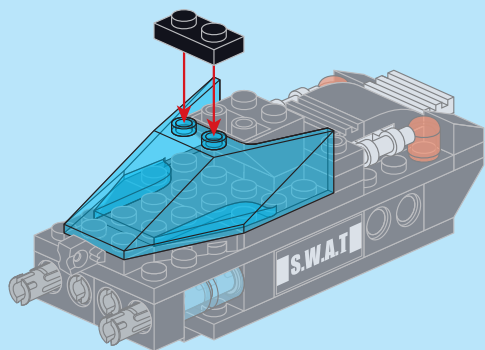
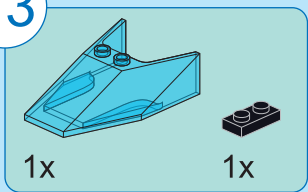

14

